

PLANIMETRIA GENERALE PREFABBRICATO BIPIANO "SERIE 2000"  
BLOCCO "A" - n° 4+4 MODULI A CAMERE SINGOLE - TOTALE N° 16 POSTI  
E  
BLOCCO "B" - N° 4+4 MODULI A CAMERE SINGOLE - TOTALE N° 16 POSTI

**PIANO TERRA**  
**BLOCCO "A"**

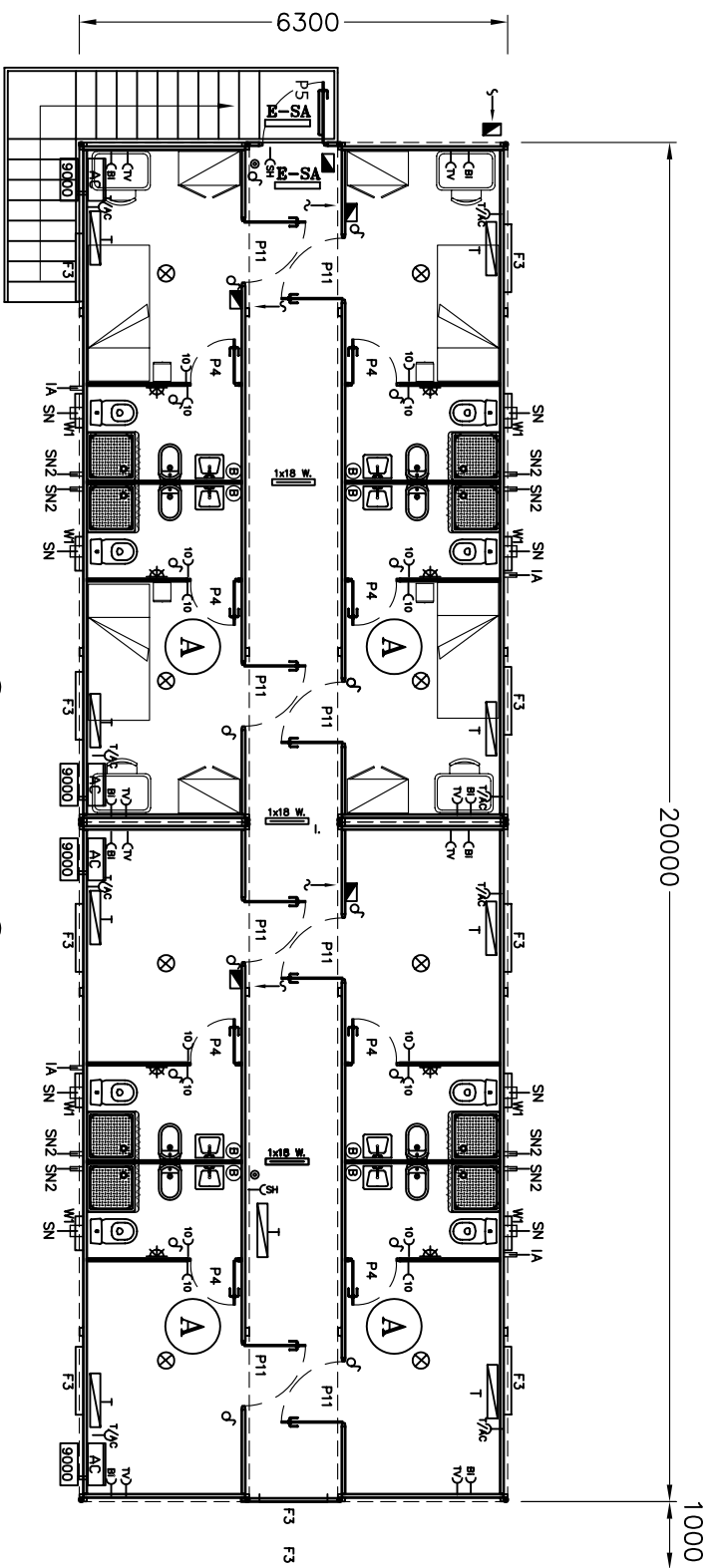

**PIANO TERRA**  
**BLOCCO "B"**

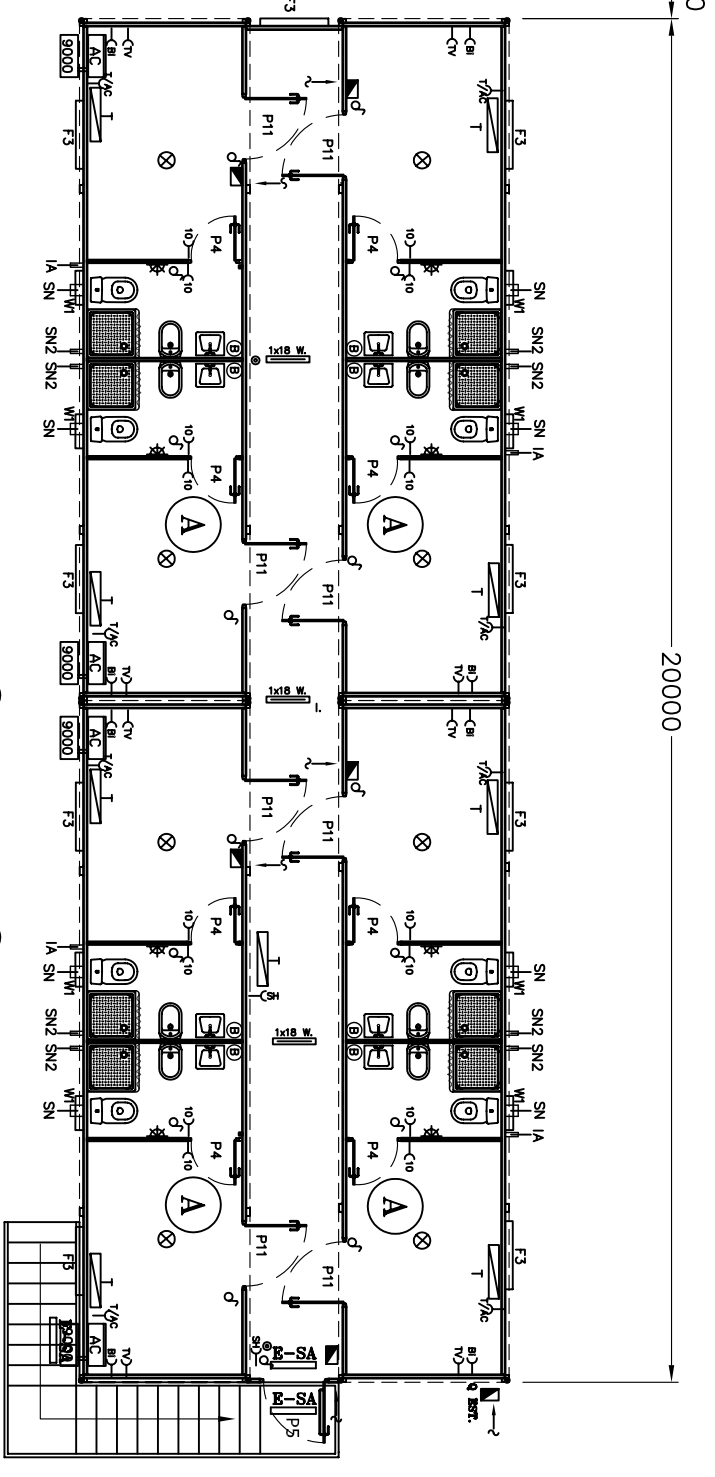

**PIANO PRIMO**  
**BLOCCO "A"**

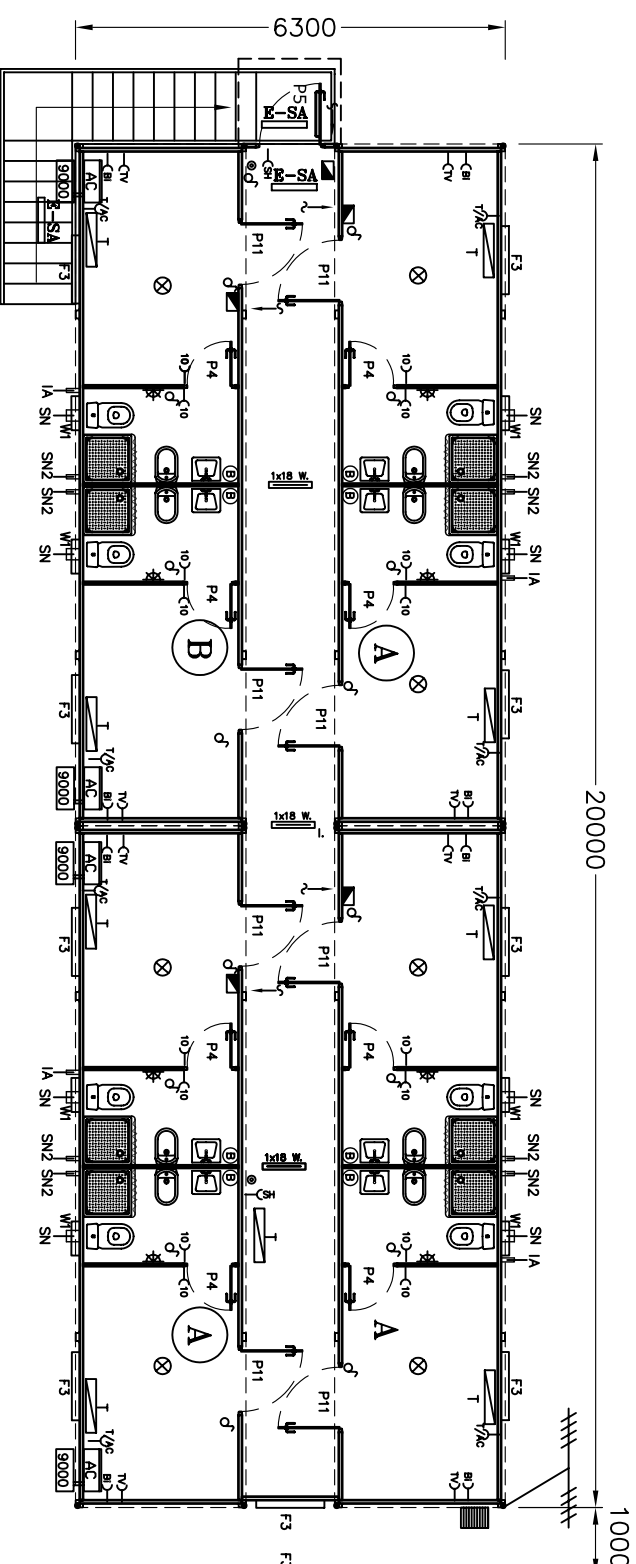

**PIANO PRIMO**  
**BLOCCO "B"**

